

# WM Keyboard base plate for 10.4" G-Win

PN# 82104T131100

## Features:

- Keyboard base plate for Keyboard mounting solutions
- 4 VESA Holes on the plate to device and 4 AMPS holes to RAM Ball (Size C)
- 135° angle fixed adjustment to avoid cabling installation

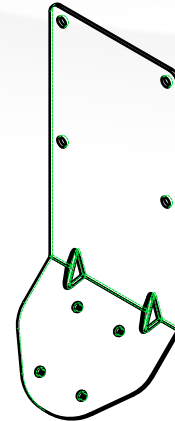

## Installing the keyboard on the keyboard base plate:

- Step 1. Position the Vertical part of the keyboard base plate on the rear of the G-WIN, aligning the holes on the back of the G-WIN with the holes on the vertical part of keyboard base plate. Attach with four M4 screws.
- Step 2. Position the sloped part of the keyboard base plate on the RAM balls, aligning the AMPS holes on the RAM ball (size C) with the holes on the sloped surface of keyboard base plate. Attach with for M4 screws.
- Step 3. Insert the RAM ball into the RAM arm and Insert another RAM ball into the other side of RAM arm and then tighten the knob on the RAM arm.
- Step 4. Mount the keyboard into the RAM ball.

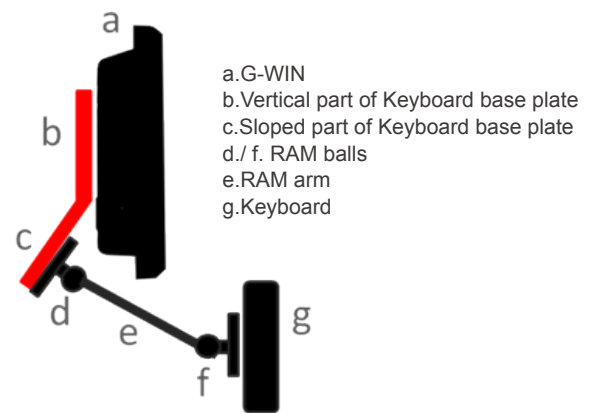

## Mechanical Drawing

